

# Chokes Drum Core Inductor CBP1253

The CBP1253 series Inductors are wound on "Drum" style ferrite cores and are ideal for use as Input/Output filter Inductors in Switch Mode Power Supplies.

- High DC levels.
- Compact size.
- Low loss Ferrite material.
- Cost effective.
- Available with heat shrink vinyl cover.
- Other applications include:  
Line Filters, Speaker  
Crossover Networks, SCR  
and Triac Controls etc.



## MECHANICAL

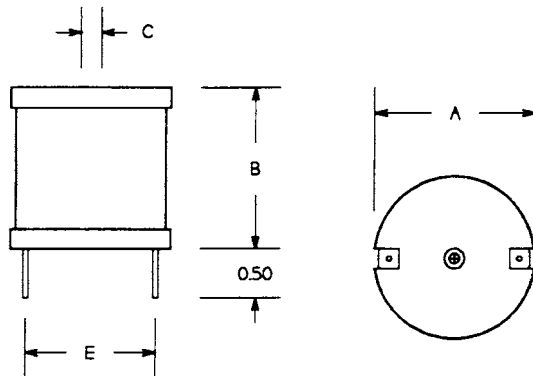

Dimensions, Inches

A	B	C	E
1.10	0.84	Hole to clear No. 4/40 screw	See Electrical Specs. table.

## ELECTRICAL SPECIFICATION

Part No.	Ind. (1) ( $\mu$ H)	Max DCR ( $\Omega$ )	I DC (2) (Amp) DC	I Rated (3) (Amp) RMS	E (Nom.)
CBP1253-22G	2.2	0.003	90.0	21.0	0.80
CBP1253-27G	2.7	0.003	74.0	21.0	0.80
CBP1253-33G	3.3	0.003	74.0	21.0	0.80
CBP1253-39G	3.9	0.003	62.0	21.0	0.80
CBP1253-47G	4.7	0.003	54.0	21.0	0.80
CBP1253-56G	5.6	0.003	54.0	21.0	0.80
CBP1253-68G	6.8	0.004	47.0	21.0	0.80
CBP1253-82G	8.2	0.004	42.0	21.0	0.80
CBP1253-100	10.0	0.006	38.0	17.0	0.70
CBP1253-120	12.0	0.008	35.0	13.5	0.69
CBP1253-150	15.0	0.009	32.0	13.5	0.69
CBP1253-180	18.0	0.010	29.0	13.5	0.69
CBP1253-220	22.0	0.011	25.0	13.5	0.79
CBP1253-270	27.0	0.012	23.0	13.5	0.79
CBP1253-330	33.0	0.017	20.0	13.5	0.79
CBP1253-390	39.0	0.022	19.0	11.4	0.79
CBP1253-470	47.0	0.024	19.0	9.0	0.75
CBP1253-560	56.0	0.026	17.5	9.0	0.75
CBP1253-680	68.0	0.029	15.6	9.0	0.75
CBP1253-820	82.0	0.032	14.0	9.0	0.75
CBP1253-101	100.0	0.034	13.2	9.0	0.78
CBP1253-121	120.0	0.046	12.1	7.2	0.75
CBP1253-151	150.0	0.064	10.8	5.5	0.78
CBP1253-181	180.0	0.072	9.7	5.5	0.78

Part No.	Ind. (1) ( $\mu$ H)	Max DCR ( $\Omega$ )	I DC (2) (Amp) DC	I Rated (3) (Amp) RMS	E (Nom.)
CBP1253-221	220.0	0.080	8.7	5.5	0.78
CBP1253-271	270.0	0.110	7.9	4.5	0.75
CBP1253-331	330.0	0.122	7.1	4.5	0.71
CBP1253-391	390.0	0.169	6.7	4.0	0.75
CBP1253-471	470.0	0.187	6.0	4.0	0.75
CBP1253-561	560.0	0.205	5.5	4.0	0.75
CBP1253-681	680.0	0.256	5.0	2.8	0.72
CBP1253-821	820.0	0.288	4.5	2.8	0.84
CBP1253-102	1000.0	0.426	4.1	2.0	0.75
CBP1253-122	1200.0	1.462	3.7	2.0	0.75
CBP1253-152	1500.0	1.518	3.4	2.0	0.75
CBP1253-182	1800.0	1.705	2.8	1.6	0.77
CBP1253-222	2200.0	1.020	2.5	1.3	0.77
CBP1253-272	2700.0	1.140	2.3	1.3	0.77
CBP1253-332	3300.0	1.270	2.0	1.3	0.75
CBP1253-332	3900.0	1.670	1.8	1.0	0.75

### Notes:

1. Inductance tolerances are all +/-20%. Tighter limits are available on request.
2. I DC is the current for which the inductance is reduced by approximately 5%. This is a reference value and may be greater on actual parts. A specific inductance drop may be specified on customer request.
3. I RATED is the rated RMS current, limited by the copper loss and wire gauge. Approximate temperature rise is 50 deg C.